

THIS DRAWING IS SUPPLIED FOR INFORMATION ONLY. DESIGN FEATURES, SPECIFICATIONS AND PERFORMANCE DATA SHOWN HEREON ARE THE PROPERTY OF THE AMPHENOL CORPORATION. NO RIGHTS OF REPRODUCTION ARE IMPLIED. ALL DIMENSIONS ARE SUBJECT TO NORMAL MANUFACTURING VARIATIONS.

Customer Drawing

REVISIONS						
REV	ZONE	ECO	DESCRIPTION	DATE	BY	APPR
A	--	--	INITIAL RELEASE	12/01/14	RW	EC
B	--	--	料号更改从HCTF20XX改为HCTF120XX	01/28/15	RW	EC
C	--	--	Remove the tin-plated terminal	05/12/20	JS	JL

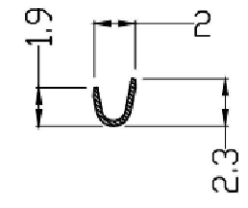
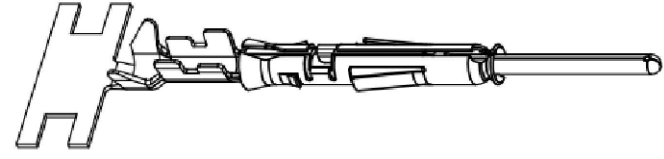
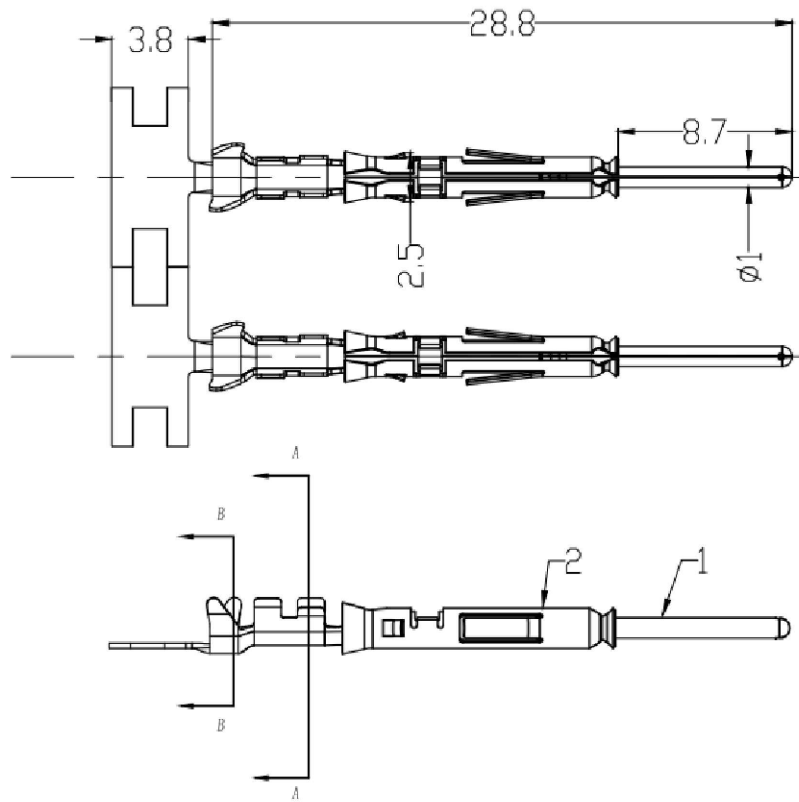

SECTION A-A

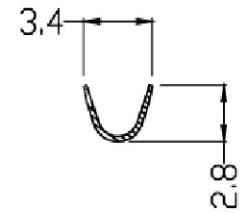

SECTION B-B

- 注 (NOTES):
- 对配母端直径 Mating contact diameter: 1.0mm
  - 额定电流 Current rating: 5A
  - 端子类型 Terminatin type: Crimp
  - 压线规格 Wire size: AWG20~22
  - 电镀信息 Plating specification: 镍底, 整个端子飘金. Gold flash plate overall.
  - 材料规格 Material specification:
    - 端子: 铜合金 Contact body: Copper alloy
    - 外套: 不锈钢 Outer spring: Stainless steel
  - 符合ROHS ROHS compliant

	Amphenol Technical Products International GZ					PART NAME:				
	第三角投影 THIRD ANGLE PROJECTION	页 面 SHEET	幅 面 SIZE	版 次 REV.	比 例 SCALE	HC Contact 20#Pin 20~22AWG				
签名 SIGNATURE		日期 DATE		UNLESS OTHERWISE SPECIFIED 1) All dimensions are in metric(mm). 2) Tolerances are as follows: 1 PL DEC ±1.00 2 PL DEC ±0.50 3 PL DEC ±0.20			DWG NO:			
制图 DRAWN	JS	05/12/20					Angles ±1°			HCTM12001
审核 CHECKED	YM	05/12/20								CUST PART #:
批准 APPROVAL	JL	05/12/20					N/A	CUST REV. -		